

Electronic control system MCS-B Topology

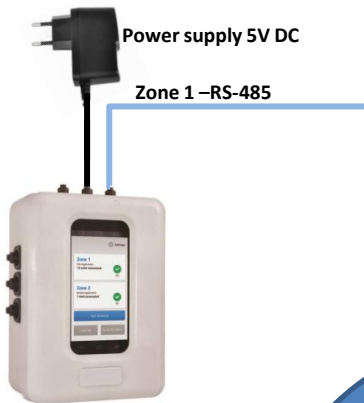

Central control unit
M60 with power
supply for 230 V AC
included in delivery

The possibility to control
up to 120 communication
modules in 2 zones



Communication is done through the BUS communication RS-485

Shielded twisted pair 120Ω at 1MHz, a cable that is used in telecommunication and computer networks. It is recommended to use the Belden 3105a cable or its equivalent

On DIP
switch set
address 1



Address 1

Possibility of
connection through
the cable or through
AMP-plug

Communication module
FSC-UFC24 for control of
one motorized fire damper
with 24 V actuator

Possible to connect one
smoke detector and
one thermoelectric
tripping device

Power supply 24 V
AC/DC is not included
in delivery, 24V DC is
recommended





Possibility of connection both dampers through the cable or through AMP-plug

Communication module FSC-UFC24-2 is used for the individual control of 2 motorized fire dampers with 24 V actuators

Option of separate power supply, or via „Daisy chain“

There is no possibility to connect smoke detector and thermoelectric tripping device

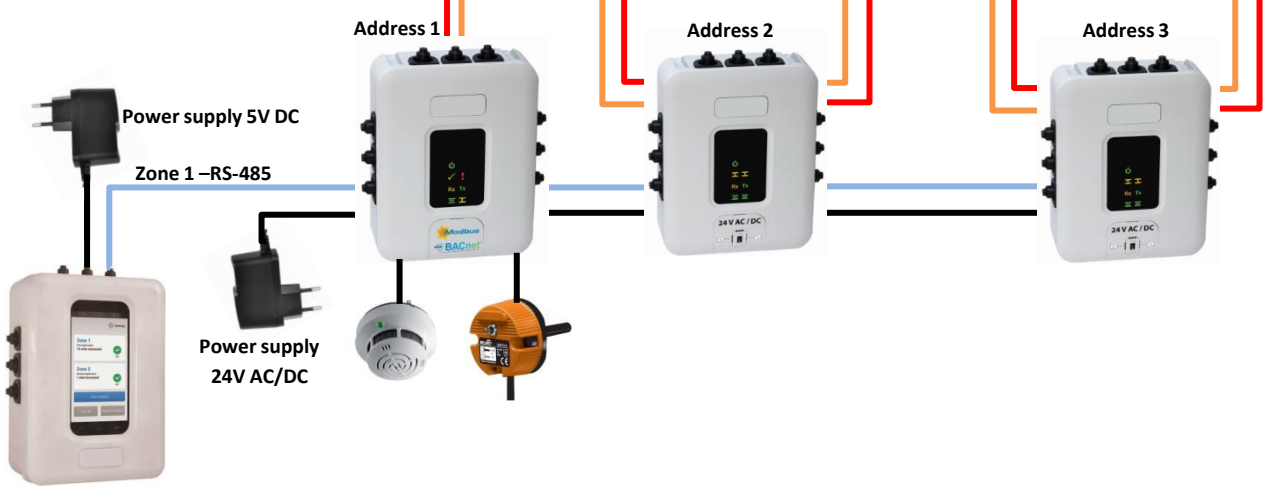



Max. distance can be extended by another 1200m using a repeater

Possibility to control up to 60 communication modules in zone 1 – addresses 1 to 60

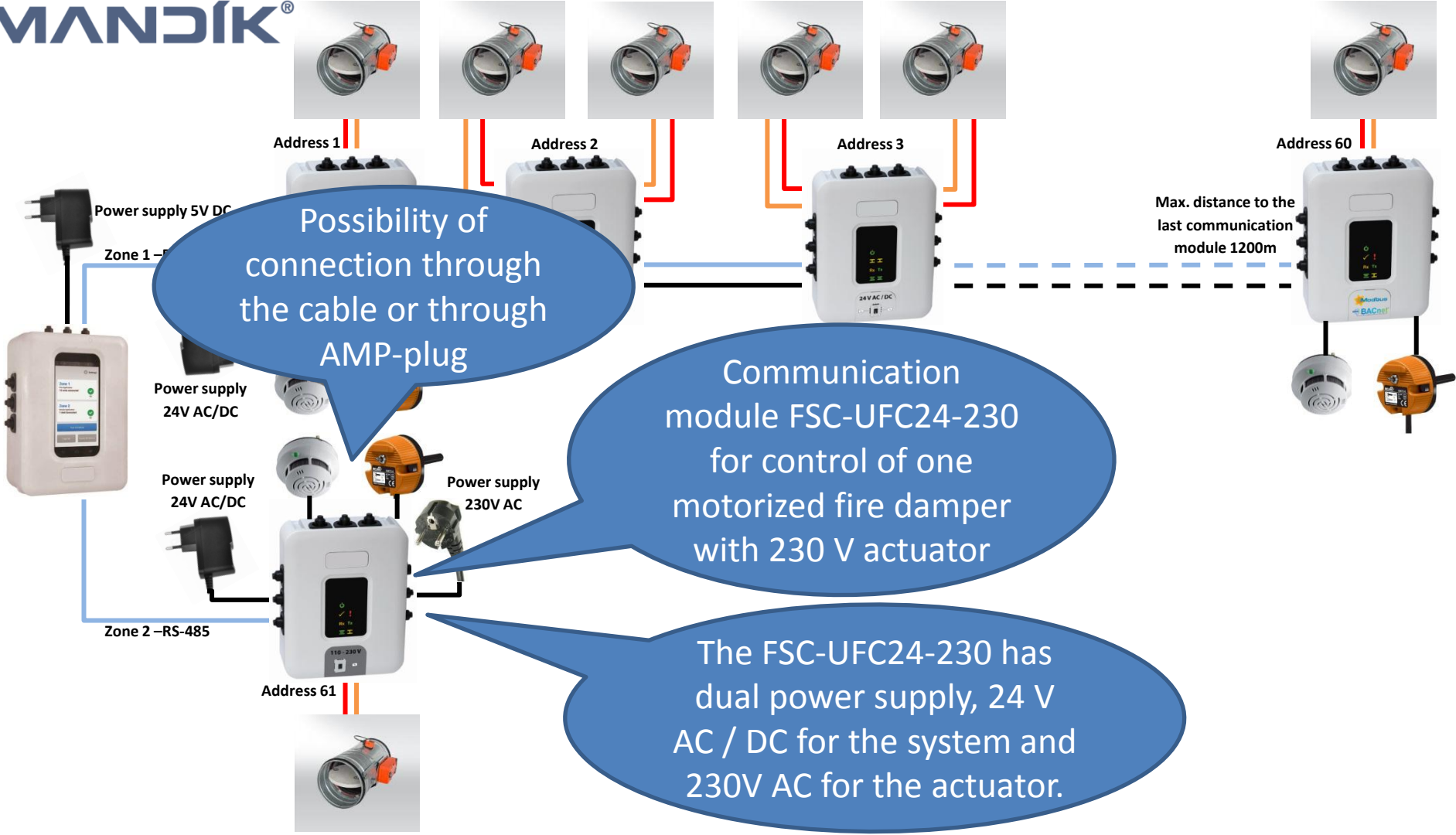

Possibility of connection through the cable or through AMP-plug

Communication module FSC-UFC24-230 for control of one motorized fire damper with 230 V actuator

The FSC-UFC24-230 has dual power supply, 24 V AC / DC for the system and 230V AC for the actuator.

Address 1

Address 2

Address 3

Address 60

Address 61

Power supply 5V DC

Zone 1 - RS-485

Power supply 24V AC/DC

Power supply 24V AC/DC

Power supply 230V AC

Zone 2 - RS-485

Max. distance to the last communication module 1200m

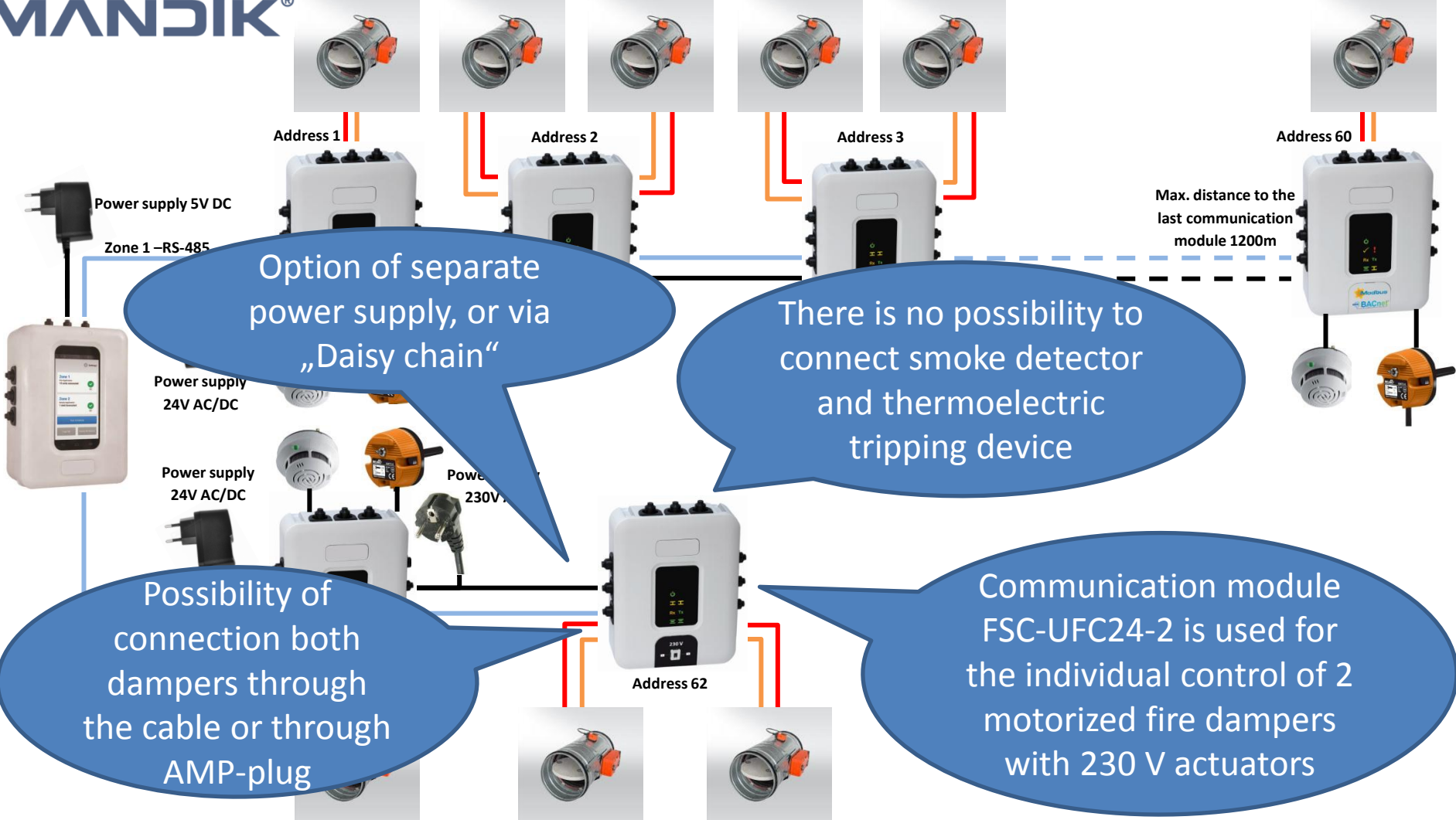

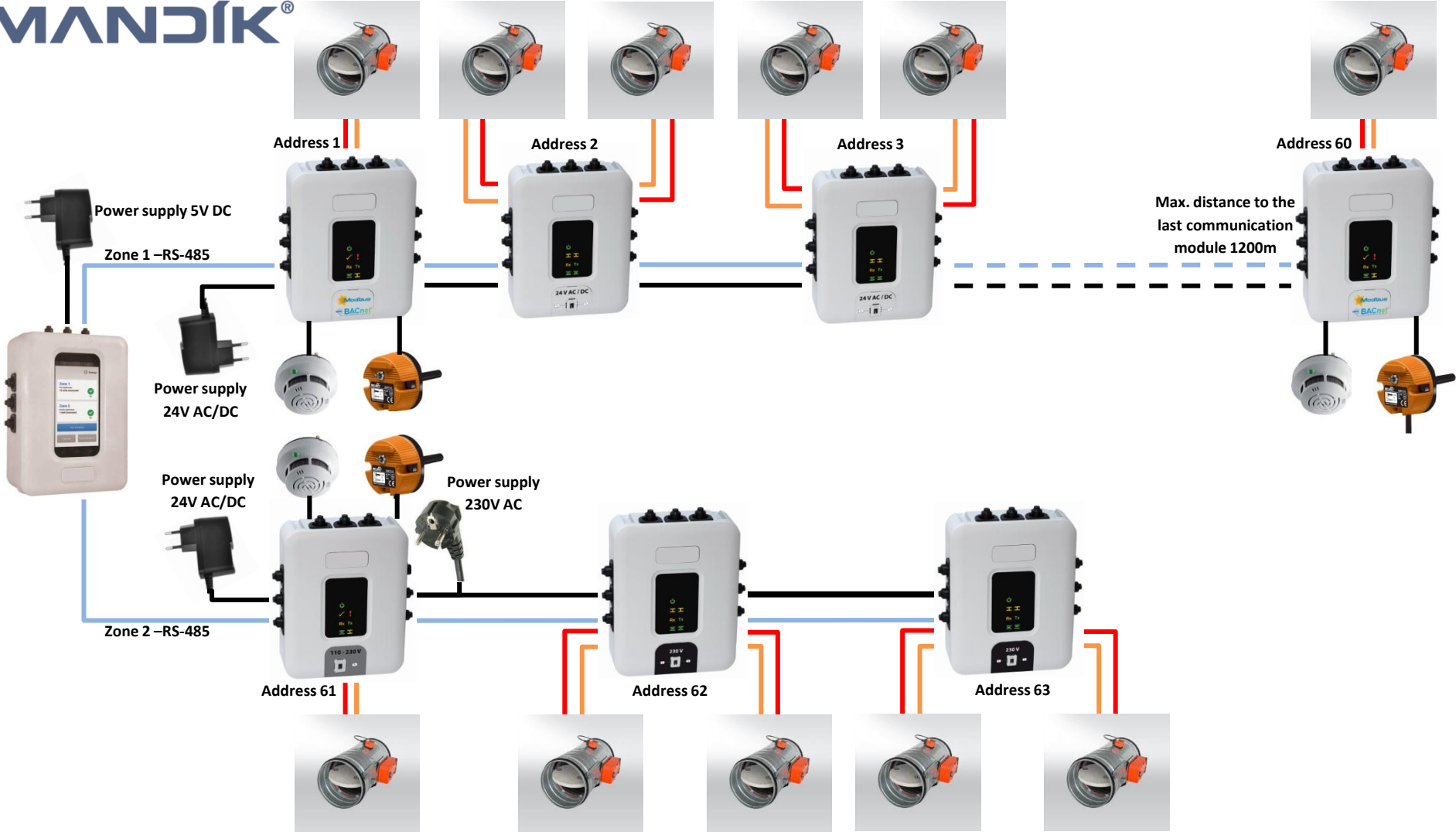

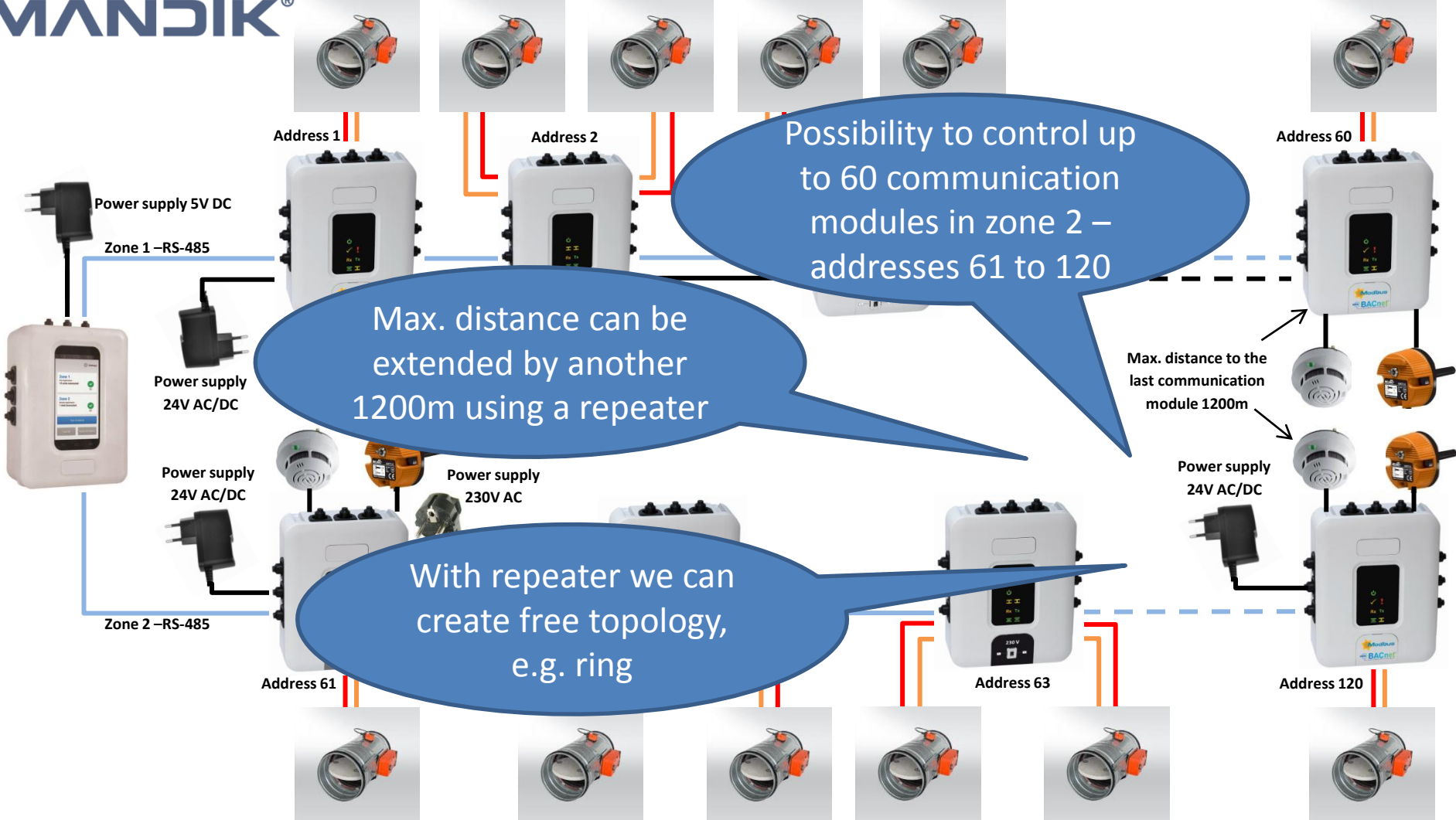

Possibility to control up to 60 communication modules in zone 2 – addresses 61 to 120

Max. distance can be extended by another 1200m using a repeater

With repeater we can create free topology, e.g. ring

Max. distance to the last communication module 1200m

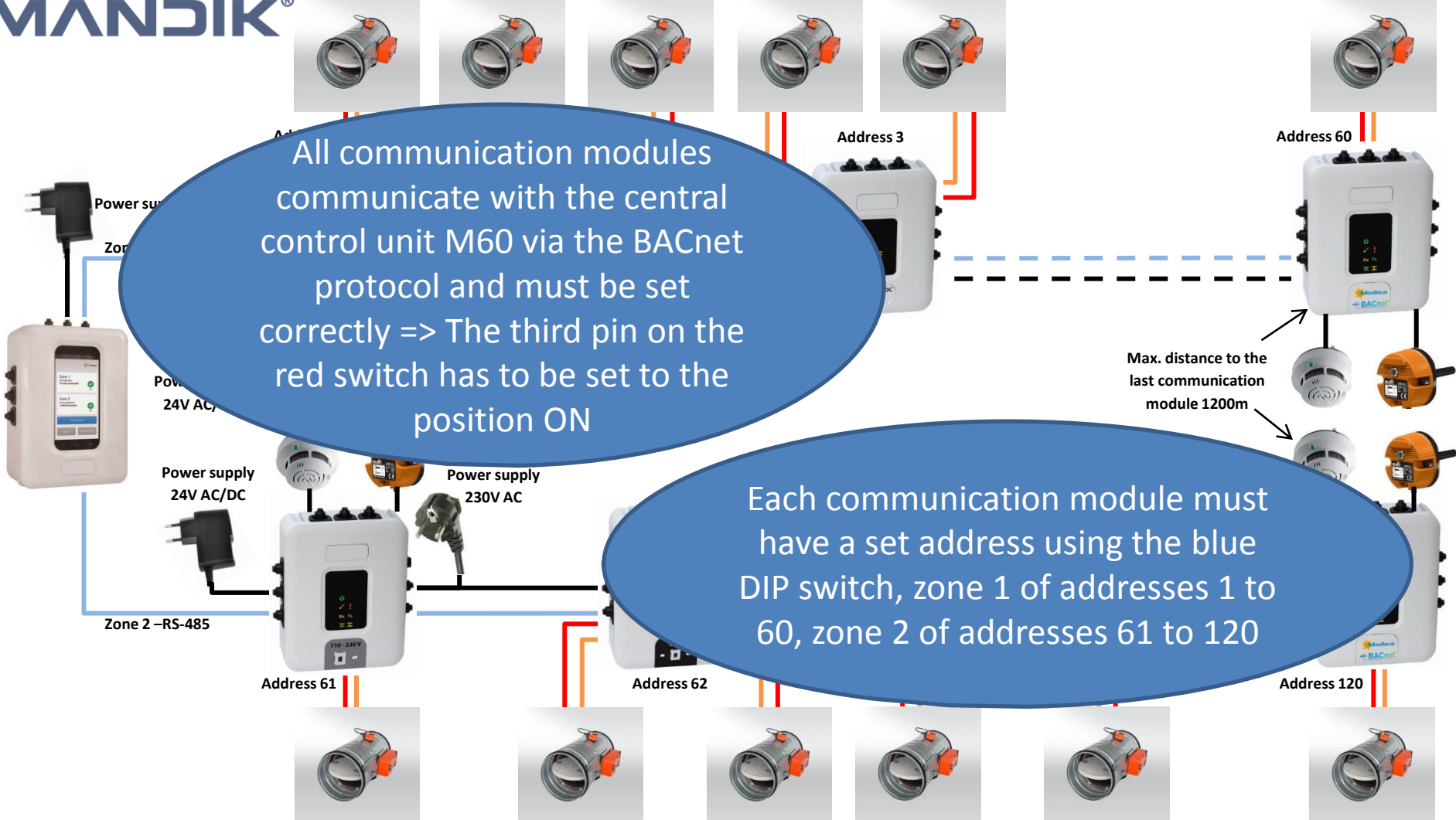

All communication modules communicate with the central control unit M60 via the BACnet protocol and must be set correctly => The third pin on the red switch has to be set to the position ON

Each communication module must have a set address using the blue DIP switch, zone 1 of addresses 1 to 60, zone 2 of addresses 61 to 120

Max. distance to the last communication module 1200m



Central control unit M60 allows a connection of a ventilation unit and an external alarm in each zone. The ventilation unit switches off when there is an alarm in the respective zone, or if a damper in the zone is closed manually



Power supply 5V DC
Zone 1 –RS-485
Power supply 24V AC/DC
Power supply 24V AC/DC
Power supply
Zone 2 –RS-485

The ventilation unit also switches off when the whole zone is tested at the same time or if an external alarm is triggered

Address 61

Address 62

Address 63

Address 120

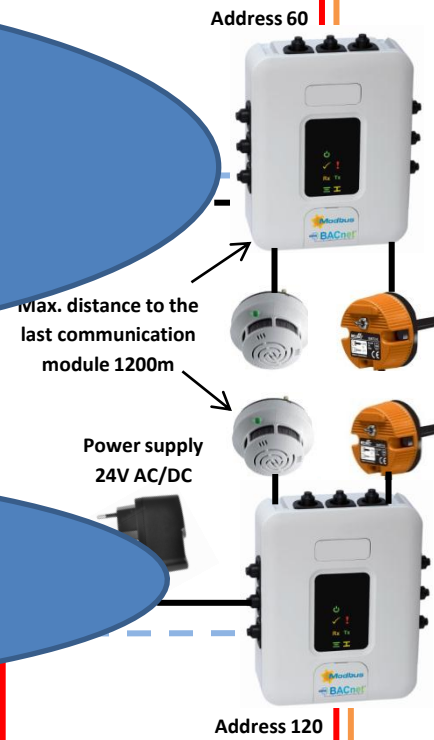
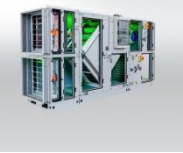

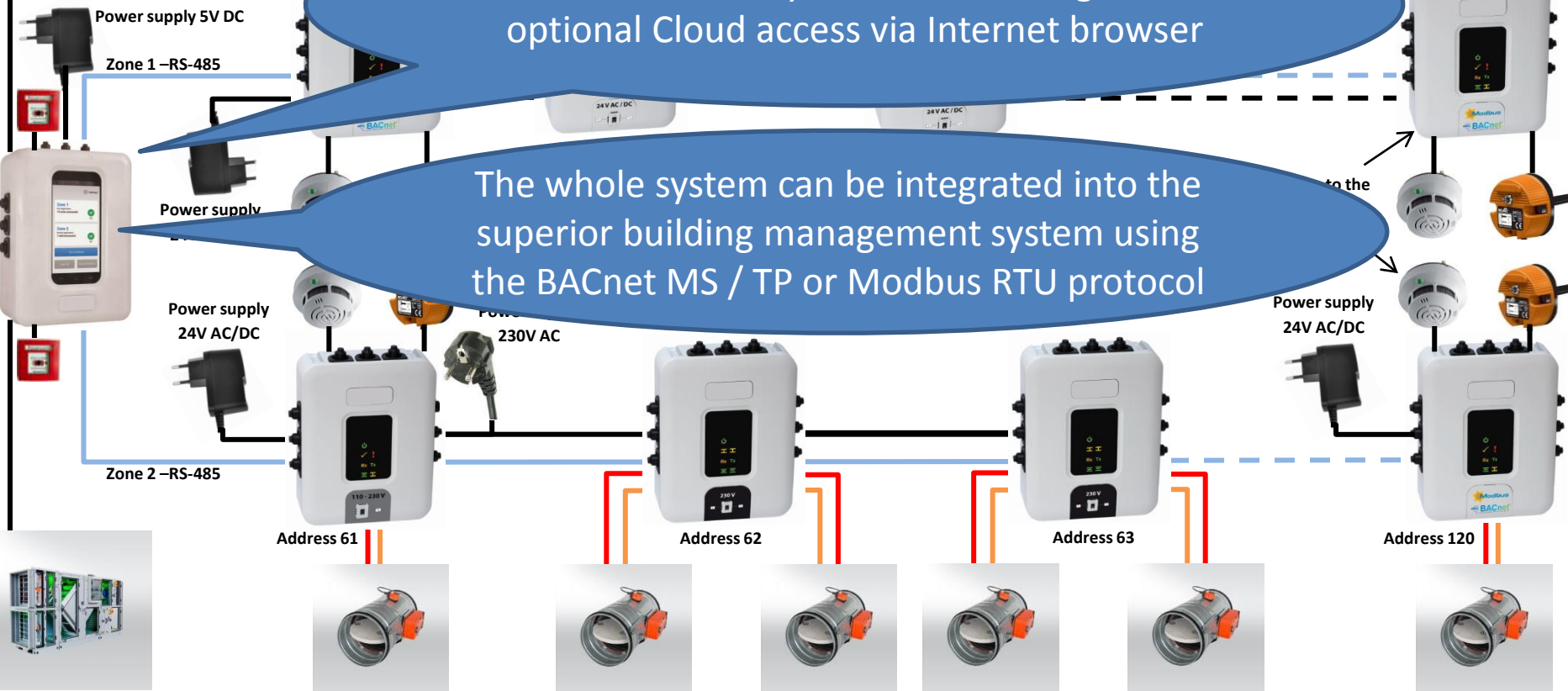

Remote access to your device through Wi-Fi, optional Cloud access via Internet browser

The whole system can be integrated into the superior building management system using the BACnet MS / TP or Modbus RTU protocol



